

Bradley Basement



3-6 Bedroom, 2-3 Bath, 3 Car Garage

Main - 2,065 Sq. Ft.

Basement - 1,733 Sq. Ft.

Girard Homes



©2017 Girard Homes LLC.

573.825.5200
www.GirardLuxuryHomes.com



Bradley Basement



3-6 Bedroom, 2-3 Bath, 3 Car Garage

Main - 2,065 Sq. Ft.

Basement - 1,733 Sq. Ft.

Girard Homes



© 2017 Girard Homes LLC

573.825.5200
www.GirardLuxuryHomes.com

Subject to change without notice



Bradley Basement



3-6 Bedroom, 2-3 Bath, 3 Car Garage

Main - 2,065 Sq. Ft.

Basement - 1,733 Sq. Ft.

Girard Homes

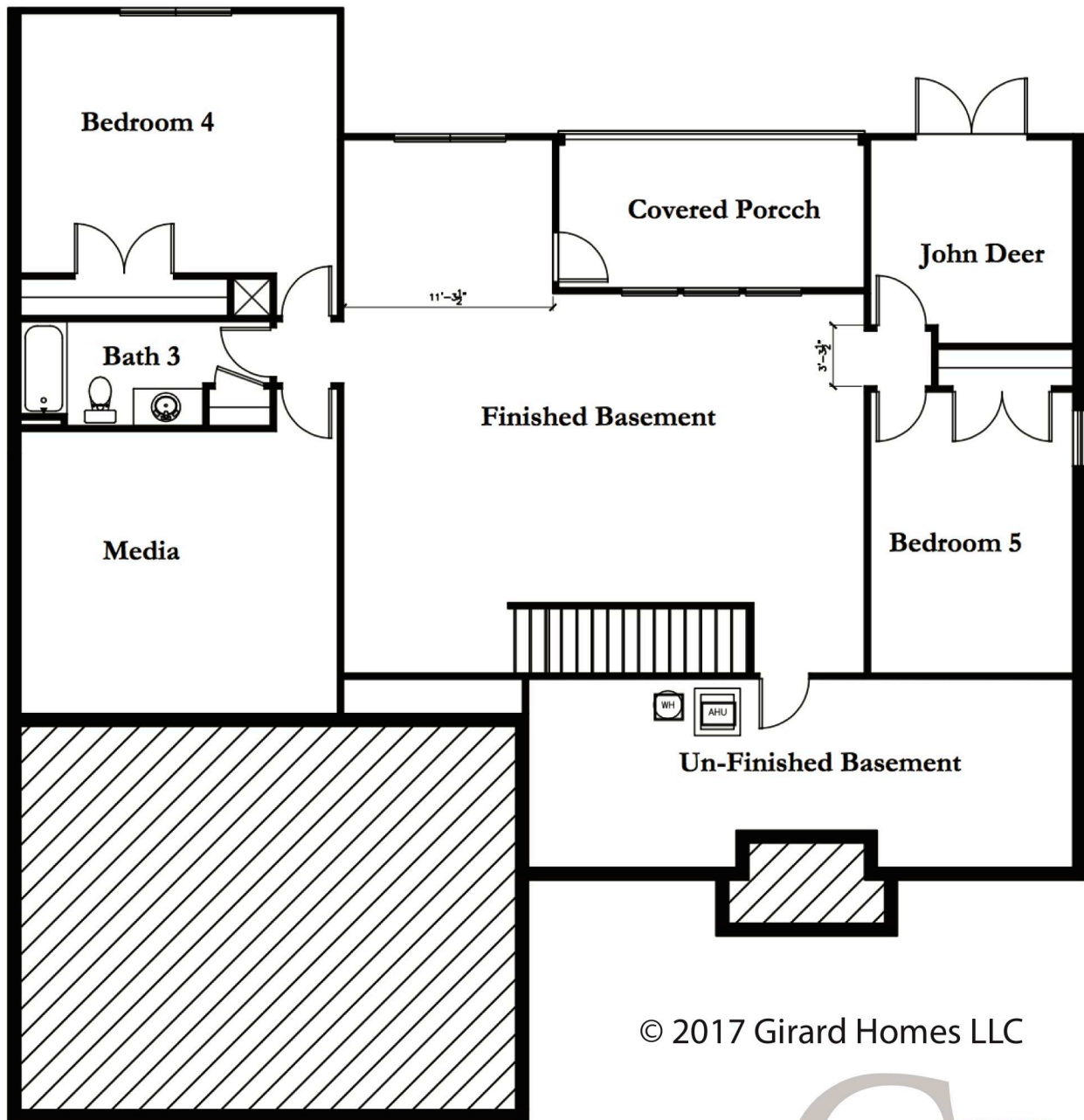

© 2017 Girard Homes LLC

573.825.5200
www.GirardLuxuryHomes.com

Subject to change without notice



Bradley Basement



3-6 Bedroom, 2-3 Bath, 3 Car Garage

Main - 2,065 Sq. Ft.

Basement - 1,733 Sq. Ft.

Girard Homes

Options

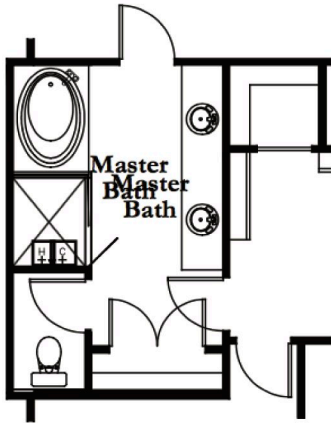

OPTIONAL MASTER BATH BUMP OUT

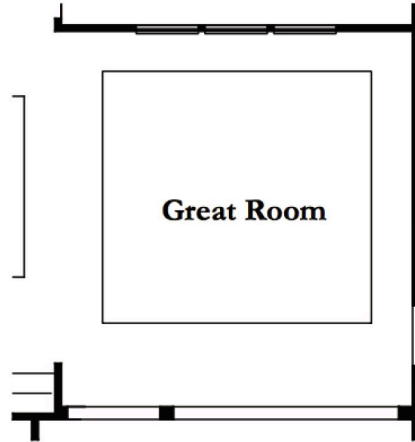

OPTIONAL TRAY AT GREAT ROOM

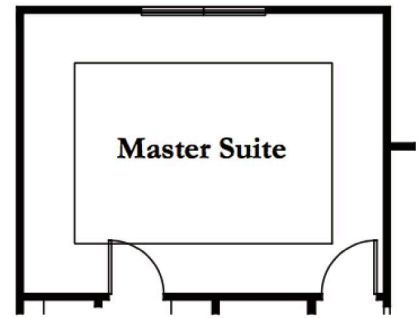

OPTIONAL TRAY AT MASTER SUITE

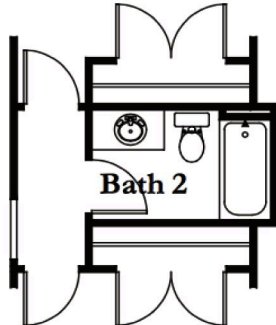

OPTIONAL DELUXE UTILITY

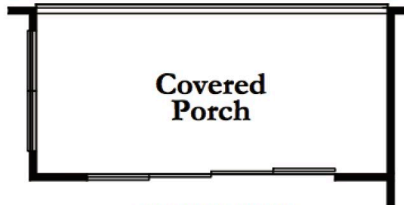

OPTIONAL SLIDING GLASS DOOR AT GREAT ROOM

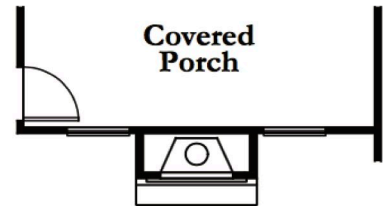

OPTIONAL FIREPLACE AT GREAT ROOM



OPTIONAL KEY DROP

© 2017 Girard Homes LLC

573.825.5200
www.GirardLuxuryHomes.com

Subject to change without notice



Bradley Basement



3-6 Bedroom, 2-3 Bath, 3 Car Garage

Main - 2,065 Sq. Ft.

Basement - 1,733 Sq. Ft.

Girard Homes

Options

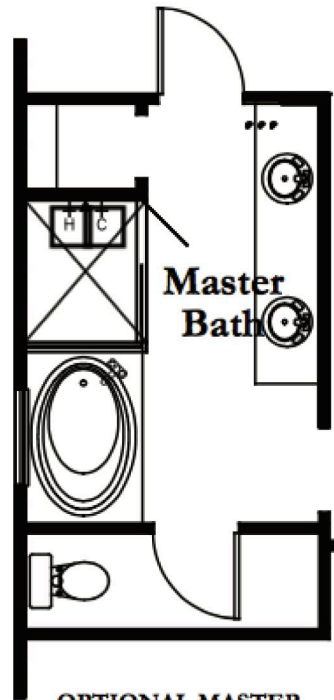

OPTIONAL MASTER
BATH

© 2017 Girard Homes LLC

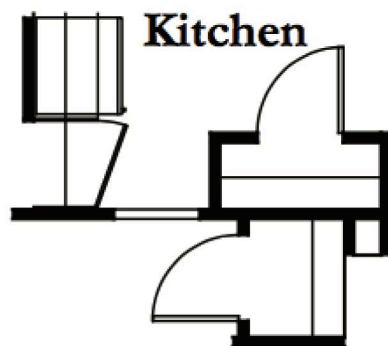

OPTIONAL WINE
CLOSET

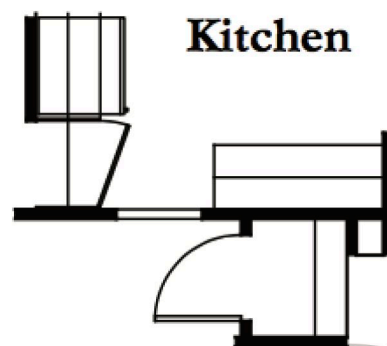

OPTIONAL CABINETS

573.825.5200
www.GirardLuxuryHomes.com

Subject to change without notice

